



Message from the Superintendent

Dear Community Members:

As many of you are already aware, New York State has given schools a unique opportunity. Through EXCEL aid funding, school districts have the ability to make necessary capital improvements to their facilities, and use the EXCEL funding to offset a district's local share. As a result, the Wayland-Cohocton Board of Education approved a resolution to present a capital project consisting of two propositions to the voters of the School District on February 13, 2007. Voting will take place in the LGI at the Wayland campus from 10 am to 8 pm.

Proposition 1 will be the EXCEL maintenance project the District has been discussing for the past several months. The New York State Legislature created EXCEL Aid as a means to distribute \$2.6 billion towards capital improvements in districts around the state. These funds are targeted at energy, health and safety, accessibility, educational technology, and physical expansion due to population growth. Wayland-Cohocton's piece of that distribution is about \$561,000. The EXCEL Aid combined with our regular state/merger aid makes us eligible for a project of approximately \$5.7 million with no expected local share. By utilizing our State mandated building condition survey that was completed this past January, we were able to develop a scope to the project that fit within the criteria outlined by the State.

A large portion of the scope of this project is involved in heating and cooling of the buildings, including installation of energy saving equipment. The scope of what we can do is limited by the structure of the funds. For instance, we are not able to use the money for things such as repairs to bus garages or athletic fields. Funding for Proposition 1 will come from the recently established EXCEL aid accompanied by typical building/merger aid on capital projects. The result will be no anticipated impact on our own tax levy from the proposition, as all of the funding will be coming through state sources.

Proposition 2 will focus on the renovation of the pool and its associated facilities. Our current pool facilities are approaching fifty years of age. As a result, we are anticipating increasing costs for upkeep and maintenance necessary to keep it operational. In addition to these increasing costs, the State Department of Health and our insurance company are telling us that the deep end of the pool is too shallow and therefore not safe for diving, be it either instructional or competitive. We have an opportunity to address these concerns by utilizing our 95% building/merger aid ratio on the reconstruction and alteration of these facilities. Consequently, there would be a minimal impact to taxpayers. On an average home assessed at \$60,000, we are anticipating an

Superintendent's Column

...continued on page 5

Project Public Hearing: Tuesday, January 30th, 7 pm, LGI
Project Vote: Tuesday, February 13th, 10 am to 8 pm, LGI

EYE OF THE EAGLE
Special VOTE Edition

Wayland-Cohocton Central School

Proposition 1

Request for voters to approve a capital project of \$5,764,000 for various repairs, renovations, upgrades, and other maintenance type of work that the District would have to complete in the near future that would be funded through the general fund budget. This project will have no anticipated impact on the local tax levy. The \$561,000 EXCEL allocation offsets the District's share of the \$5,764,000 project. The District receives about 95 cents back from State building aid on every dollar that is spent. Combining the aid categories results in a no cost project for taxpayers.

EXCEL Aid Capital Project

Proposition 1: Questions & Answers

On **February 13, 2007 between 10 am and 8 pm**, the polls will be open in the Large Group Instruction (LGI) room for residents to vote on the proposed \$5,764,000 capital project (Proposition 1). Absentee ballots will also be available beginning January 15, 2007 in the Business Office from 8 am to 4 pm. The Board of Education will host a public meeting on **Tuesday, January 30, 2007 at 7 pm** in the LGI to answer questions regarding the project.

What is EXCEL aid?

EXCEL aid (*Expanding Our Children's Education and Learning*) was approved by the State last spring and provides \$1.8 billion for New York City schools and \$800 million for all other schools throughout the state to fund specified types of school construction projects. Wayland-Cohocton's share of this aid package is \$561,125.

How will this project impact our local property taxes?

If all goes according to plan, there will be no increase in local property taxes due to this project. Based on the approved legislation, the EXCEL aid can be used to pay for the local share of the project. The *local share* is the cost of a capital project after state building aid that district residents would typically pay through their property taxes. Working with its financial and bond consultant Bernard P. Donegan, Inc., the District has been conservative in estimating the project total in the amount of \$5,764,000 so that there would be no planned impact on local property taxes. The EXCEL aid may be used to pay the local share of the project resulting in a total project of \$5,764,000. (Wayland-Cohocton is reimbursed for 95 percent of the project through regular State building aid.)

If there is likely no impact on local property taxes, why must residents vote on the project?

State regulations require that capital projects be approved by the voters. Therefore, approval by the voters is required for the district to undertake this project.

What kind of work can be done in the project with the EXCEL Aid funding?

The State regulations are quite specific allowing only certain types of work to be done with these funds. There are five categories that qualify: educational technology, health and safety, accessibility, physical capacity expansion and energy.

How did the District determine what specific items to include in this proposed project?

The District has over 400,000 square feet of buildings and monitors their condition and potential needs on an on-going basis. Further, as part of State requirements, the District last year completed its five-year building condition review involving input from the district along with evaluation by the district's architect and engineers. As a result of this preparation, the district and its architect, were able to determine and prioritize the work to include in this project. Additionally, Superintendent Michael Wetherbee and the District's architect, The Thomas Group, consulted with NYS Education Department officials in Albany to ensure that the proposed work meets the State's regulations to qualify for EXCEL Aid.

What items are included in the proposed scope of work for this project?

Approximately \$5.8 million in work has been identified and categorized as either priority or alternate. The

Proposition 1 Q&A continued from previous page

exact amount of work that can be completed cannot be identified until the project is bid and firm costs are known. Except for some site work, the majority of the work involves electrical and HVAC upgrades along with technology infrastructure enhancements. Listed below are the major project components.

VOTE - February 13, 2007

State Approval - projected by March 15, 2008

Contracts awarded - Spring 2008

Construction work - Summer 2008

What are the key dates for the project?

Public Meeting - January 30, 2007

Absentee ballots available January 15, 2007

You didn't answer a question that I have. How can I find out more information?

Contact Superintendent Michael Wetherbee at 728-2211 or Business Manager David Mastin at 728-2212.

EXCEL Aid Project Components

MAIN K-12 CAMPUS (WAYLAND)
Door and window repairs to reduce thermal loss
Replace pool HVAC systems
Replace steam heating system with a high efficiency hydronic boiler system
Replace old pneumatic controls with new electronic controls
Provide economizer cooling (up to 100% outside air) for high school wing
Technology upgrades
Radon mitigation in select classrooms
Replace stage rigging with a safer system
Provide additional exterior lighting
Safety updates for identified classrooms
Improve air conditioning systems for various rooms and library
Security system improvement/additions
Replace the door hardware on interior and exterior doors to meet ADA guidelines
Improve air distribution in auditorium
COHOCTON CAMPUS
Replace older glazing in windows to reduce thermal loss
Security system improvements/additions
Technology upgrades
Replace stage rigging with a safer system
Replace smoke doors that are not functioning properly
Improve air conditioning in the computer classroom
Relocate pole mounted transformer away from classroom rescue window
Replace original power panel and cloth wiring with newer, safer systems
Replace the original domestic water piping

Proposition 2

Request for voters to approve a capital project of \$5,214,000 for reconstruction, alterations, and additions to the pool and its associated facilities. The District receives about 95 cents back from State building aid on every dollar that is spent. Combining this aid with money from the District's debt service reserve fund will result in a minimal local tax impact. On an averaged assessed home of \$60,000, we anticipate an annual increase of \$3 for a home that qualifies for the basic STAR exemption.

Pool Renovation Capital Project

Proposition 2 Questions & Answers

On **February 13, 2007 between 10 am and 8 pm**, the polls will be open in the Large Group Instruction (LGI) room for residents to vote on the proposed \$5,214,000 capital project. Absentee ballots will also be available beginning January 15, 2007 in the Business Office from 8 am to 4 pm. The Board of Education will host a public meeting on **Tuesday, January 30, 2007 at 7 pm** in the LGI to answer questions regarding the project.

Why does the pool need renovations?

The pool is approaching 50 years of age, as well as the end of its useful life expectancy. As a result, we are anticipating increasing costs for upkeep and maintenance necessary to keep it operational and energy efficient. In addition, the State Department of Health and our insurance company have both stated that the depth of the pool is unsafe.

Why is a separate vote and proposition necessary?

The renovations to the pool that are being proposed do not qualify for EXCEL funding as per the New York State Department of Education guidelines for EXCEL aid. To maximize state aid generated by the projects it was best to keep the two separate from one another.

How will this proposition impact our local property tax?

We are anticipating a minimal impact to the local taxpayers. As stated earlier, the District is eligible for 95 percent building/merger aid through June 30, 2008 on alterations and reconstruction of existing facilities.

At this point, we are estimating that for an average assessed home (\$60,000 value) qualifying for basic STAR exemption there will be an annual cost of \$3, over 15 years.

What are the benefits of a renovated pool and associated facilities?

First and foremost, it would provide a safer instructional environment for our students. Additional benefits would be a more energy efficient system and a facility that offered accessibility for ADA requirements.

Can one proposition pass without the other?

The EXCEL project proposition can be approved in isolation. However, the approval of the pool project is contingent on the passing of the EXCEL project proposition.

What are the key dates for the project?

Public Meeting - January 30, 2007

Absentee ballots available January 15, 2007

VOTE - February 13, 2007

State Approval - projected by March 15, 2008

Contracts awarded - Spring 2008

Construction work - Summer 2008

You didn't answer a question that I have. How can I find out more information?

Contact Superintendent Michael Wetherbee at 728-2211 or Business Manager David Mastin at 728-2212.

Pool Project Components

Pool Area Renovations
Raise the roof structure to allow for proper overhead clearances
Replace kalwall windows
Create new entry area for community
New pool equipment
1,300 square foot addition
New bleachers with handicap accessibility
Aquatics office
Remove and replace pool shell
Provide a new pool shell that will be positioned within the existing footprint of the building
Deepen to 12'6" to meet safety requirements
Widen by 10', making pool 6 lanes
Locker room renovations
Renovate Middle School boys' locker room and pool locker room - replace lockers and meet ADA requirements
Renovate girls' pool locker room - entry area will be reconfigured due to pool expansion, replace lockers and meet ADA clearance requirements

Superintendent's Column

...continued from front page

annual cost of \$3 for a home qualifying for the basic STAR exemption.

A public meeting on the proposed project will be held on January 30, 2007 at 7 p.m. in the LGI. The Board of Education invites you to attend this meeting in order to provide the necessary information and answer any questions that will allow you to make an informed decision. If you would like more information on this pending capital project, visit the EXCEL link on the *Featured Links* portion of our website. Thank you for your continued support of Wayland-Cohocton Central Schools and our students.

Very Truly Yours,
Michael J. Wetherbee

Proposition 1: EXCEL Project

Project Cost Summary:
\$5,764,000

Project Revenue Sources

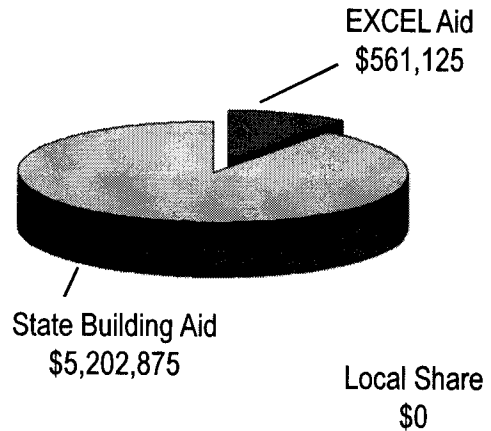
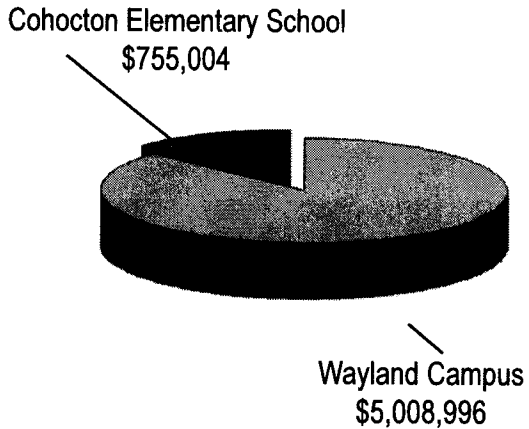

Proposition 2: Pool Expansion

Project Cost Summary:
\$5,214,000

Project Revenue Sources

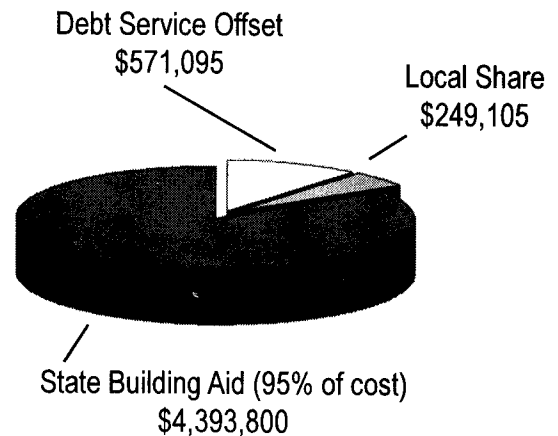
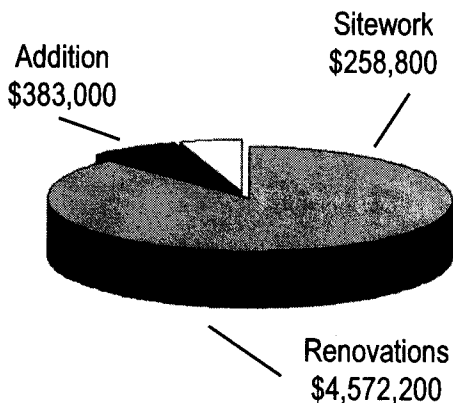

Average Cost of Homeowner

(during 15 year repayment period)



Full Value Assessment	EXCEL Proposition 1	Pool Proposition 2	Annual Increase	Per Month Increase
\$40,000	\$0	\$1	\$1	\$.08
\$60,000	\$0	\$3	\$3	\$.25
\$80,000	\$0	\$5	\$5	\$.42
\$100,000	\$0	\$7	\$7	\$.58
\$120,000	\$0	\$9	\$9	\$.75

Typical Home: \$60,000

The typical homeowner will pay approximately \$3 more per year over the 15-year repayment period. ** Figures assume the Basic STAR exemption.

Pool Project Plan

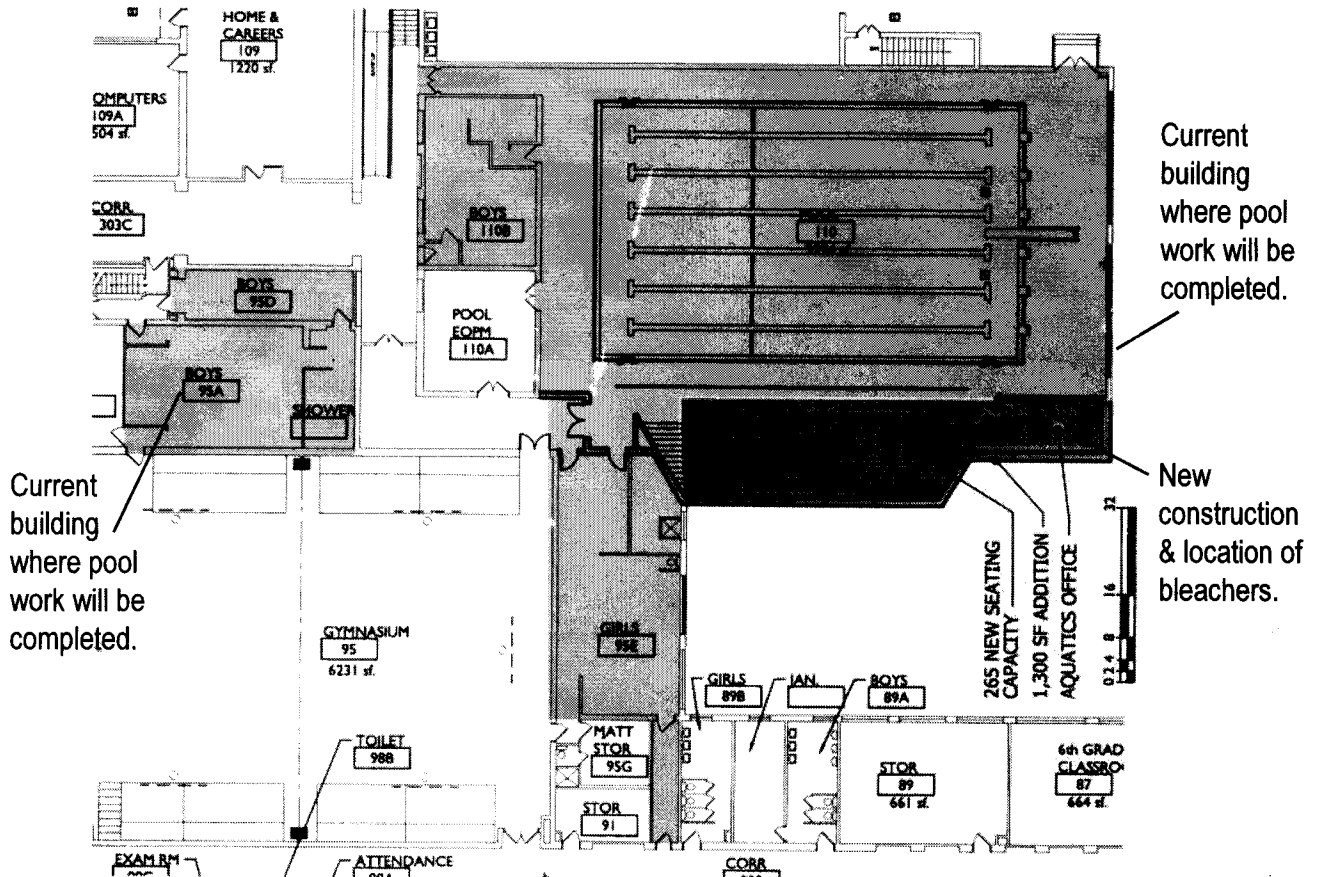

Public Hearing

Tuesday, January 30, 2007
7 pm, LGI
Wayland Campus

Information about both projects and
opportunity to ask questions

VOTING

Tuesday, February 13, 2007
10 am to 8 pm
LGI, Wayland Campus

Voter Qualifications:

18 years of age,
US citizen
Resident of the district for at least
30 days prior to the vote

Absentee Ballot Information:

Absentee ballots will be available
in the Business Office
Monday through Friday
8 am to 4 pm
Applications for absentee ballots
must be submitted to
the district clerk by February 6th

If you have any questions, contact the
Business Office at 728-2212.

Wayland-Cohocton Central School
2350 Route 63
Wayland, NY 14572

585.728.2211

PRE-SORT
Nonprofit Org.
U.S. Postage Paid
Wayland, NY
Permit #14

Board of Education

David Wallace, President
Valerie Stephens, Vice President
Charles Brewer
Suzanne May
Mike Parks
Mark Perkins
John Sick

POSTAL PATRON

Superintendent of Schools
Michael J. Wetherbee